

"Homework" exam, TAM 2020, Dec 4, 2010

1) RP 4, 1, 2, 3

Find tension in AC.

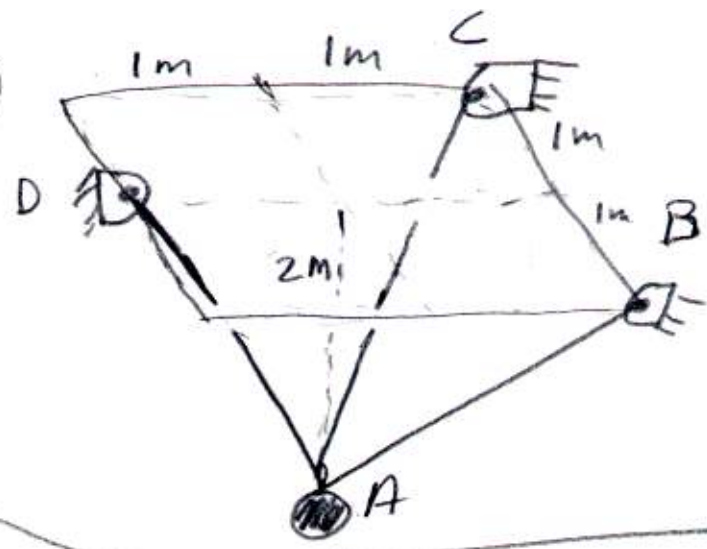

$m = 1 \text{ kg}$
 $g = 10 \text{ N/kg}$

2) RP 5, 1, 1, 3

- Find & clearly mark all of the zero force members.
- Find the tension or compression in any non-zero force member (you choose).

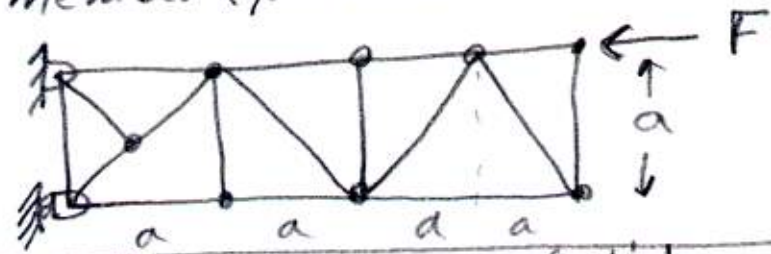

4) B5 9, 34
Deflection at H = ?

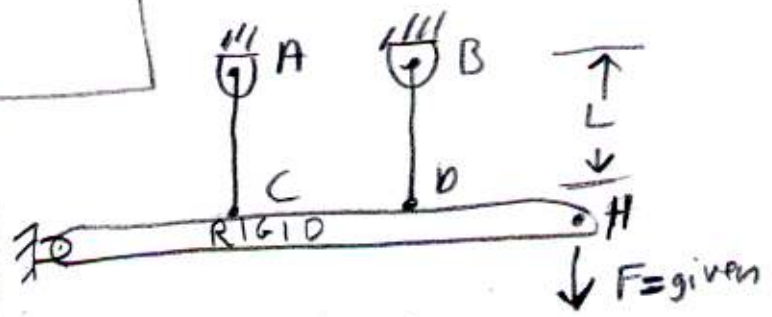

3) RP 6, 3, 16

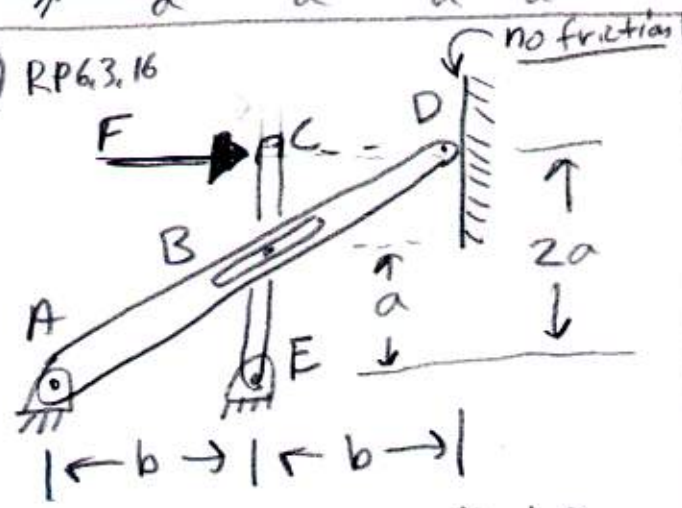

Find force at wall at D
(Given a, b, F)

$\leftarrow a \rightarrow \leftarrow a \rightarrow \leftarrow a \rightarrow$
AC & AD
cross section \rightarrow A, E, G, Q, V
given